



NORTH POINT



Ground Floor Plan

0459

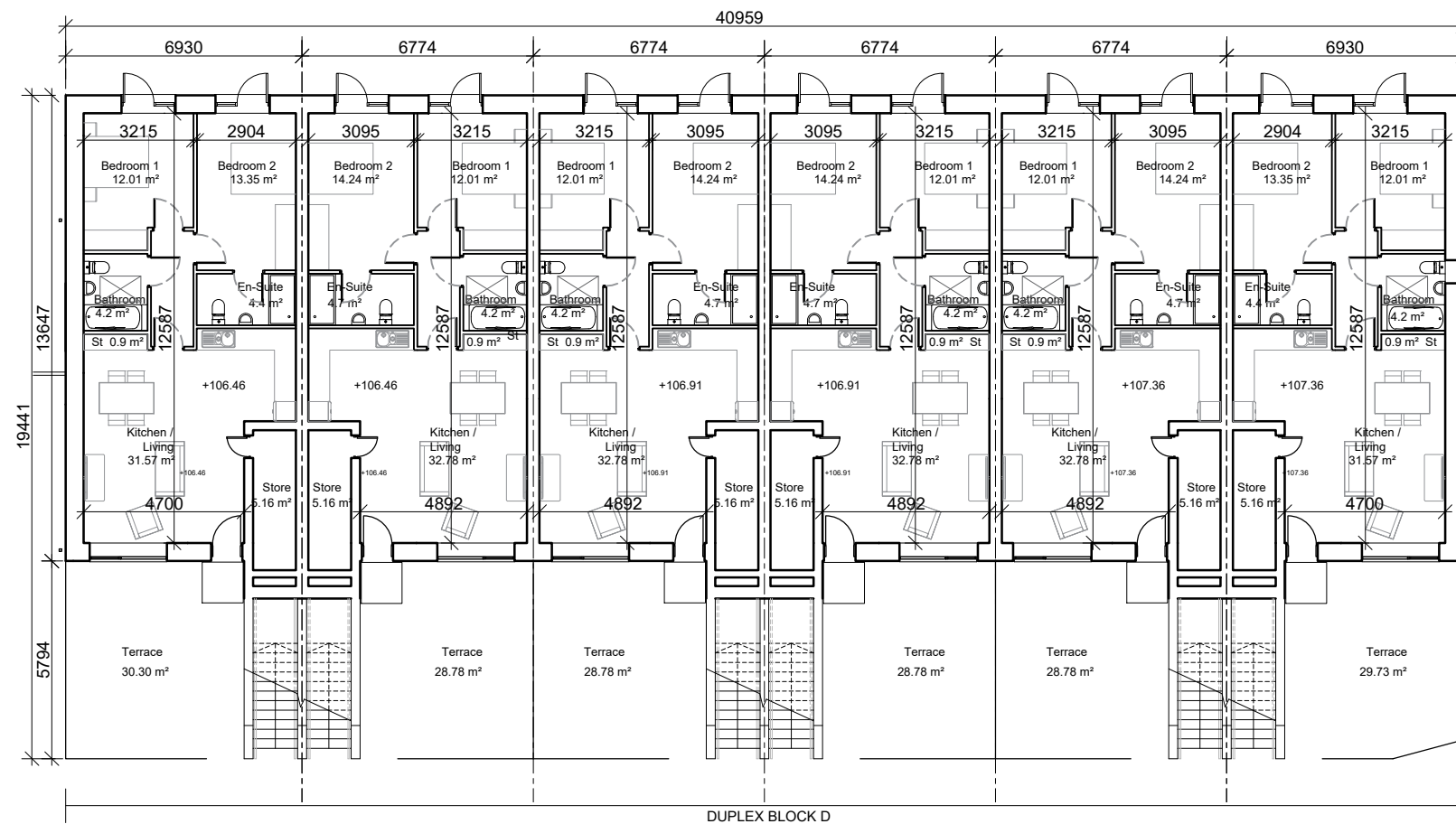

DUPLEX BLOCK D



NORTH POINT



First Floor Plan

0459

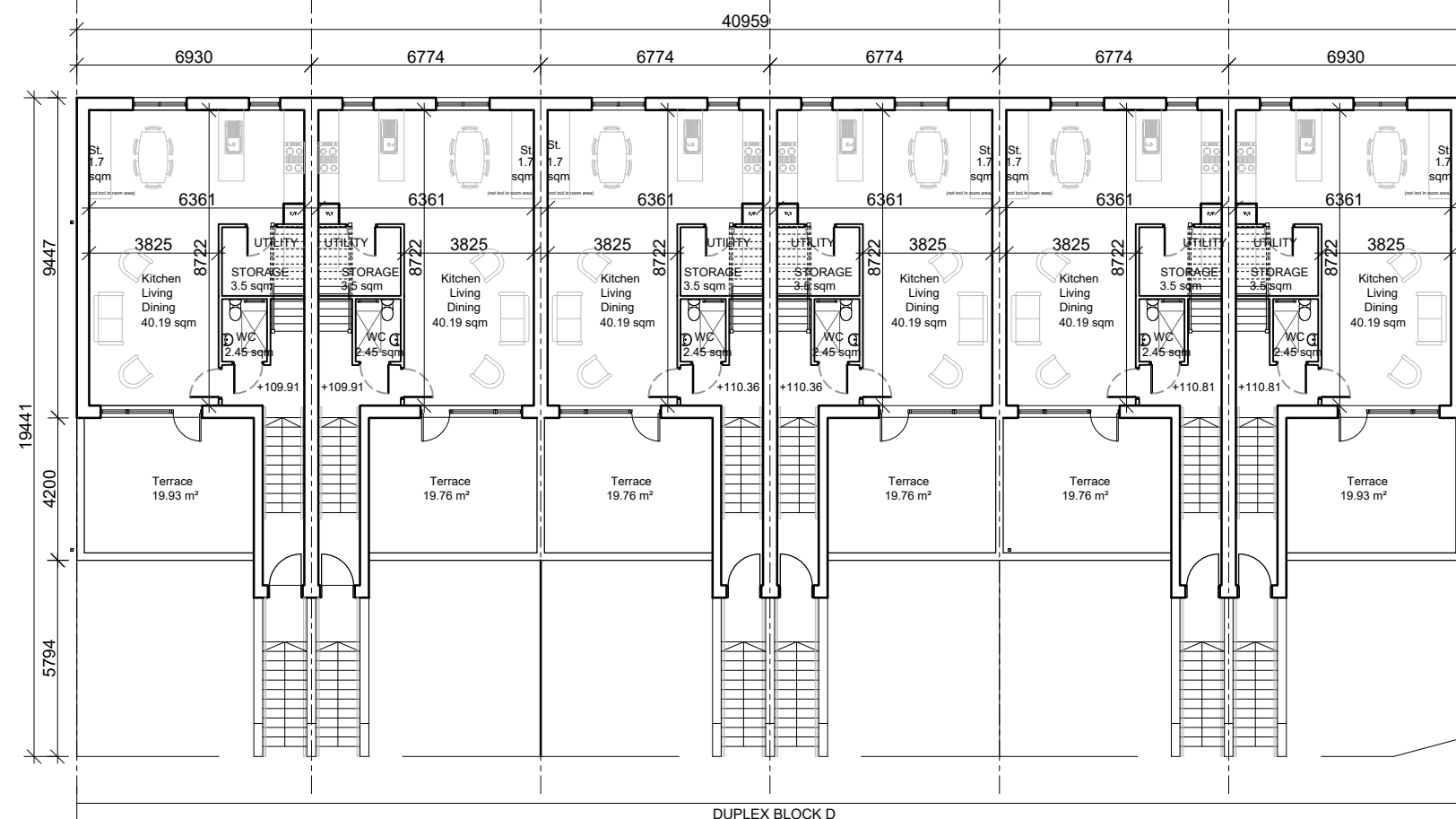

DUPLEX BLOCK D

DUPLEX TYPE D LOCATION

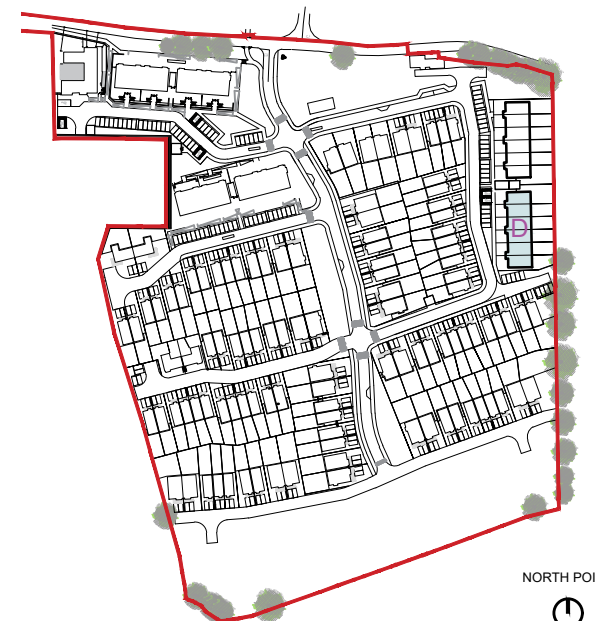

NORTH POINT

KEY PLAN NOT TO SCALE

NOTES / LEGEND

GROUND FLOOR END TERRACE UNIT TOTAL AREA 79.29 SQM
GROUND FLOOR MID TERRACE UNIT TOTAL AREA 81.73 SQM
UPPER FLOOR END TERRACE UNIT TOTAL AREA 117.47 SQM
UPPER FLOOR MID TERRACE UNIT TOTAL AREA 117.50 SQM

1.3 Sqm storage of each upper floor unit located in attic space. Access and flooring to attic.

Key Plan:

Rev.	Date:	Description:	By:

Stage:

PLANNING



2 Donnybrook Road,
Donnybrook,
Dublin 4, Ireland
Telephone +353 1 218 3900
www.molaarchitecture.com

Client: Cairn Homes Properties Ltd.

Project: Cookstown Road Enniskerry

Drawing: Duplex D- Ground & First Floor Plan

Date: Feb 2021 Scale: 1:200 at A3 Sheet: 3 Int. Job No: 19010
Drawing No.: 19010_MOLA_A00_00_DR_A_XX_A00_0459 Status: Revision: 00

Notes
Do not scale.
Use figured dimensions only.
This drawing is to be read in conjunction with all relevant specifications and drawings.
All dimensions to be checked on site.
In the event of any discrepancies between drawings, the contractor is to inform the Architect immediately.
© COPYRIGHT This drawing or design may not be reproduced without permission